

OMNIA
Smart Devices



Wireless Smart Gateway Zigbee & Bluetooth
Hub Inalámbrico Inteligente Zigbee & Bluetooth

OMHUB-C

Product specifications

Model	OMHUB-C
Product name	Wireless Smart Gateway
Electrical Parameters	5V 1A
Operating Temperature	-10°C-45°C
Operating Humidity	5%-90%RH(no condensation)
Charge Type	Type-C DC 5V
Wireless Protocol	Wi-Fi 2.4GHz & ZigBe
Frequency Band	2.400-2.483GHz
Maximum Radio Transmit Power	<+19dBm □ □

Packing list

- Wireless Smart Gateway
- Instruction manual x 1
- Power cable x 1

Transportation

1.The products shall be free from severe vibration, impact, exposure to rain, dumping and other problems during transportation, and shall comply with the provisions of the marks on the packing boxes.

2. This product has no waterproof and dustproof function.

Storage

Products should be put in the warehouse where the temperature is between the range $-10^{\circ}\text{C} \sim +45^{\circ}\text{C}$, and the relative humidity between the range 5%RH~90%RH(non condensation), indoor environment with no acid, alkali, salt and corrosive, explosive gas, flammable matter, protected from dust, rain and snow.

Warnings

Do not disassemble, reassemble, modify, or attempt to repair the product by yourself. Such products may cause electric shock, which may cause serious injury or death.

Product Description

The smart gateway is the control center of the ZigBee and Bluetooth device. Users can design and implement smart applications scenarios by adding ZigBee and Bluetooth device

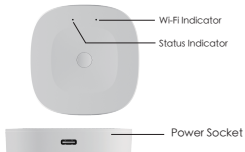

OMNIA

①WiFi Indicator(Red):
Configuration Status:

Steady On	Successful connection
Blinks	Ready for connection
Bluetooth/AP mode	Explained as 1500ms ON and 1500ms OFF
Steady Off	Successful configuration but the network is disconnected

②Status Indicator(Blue):

Steady On	Activated
Blinks	access learning mode as 500ms ON and 500ms OFF
Steady Off	Unactivated

Preparation For Use

1.Download Smart Life App



Please scan the QR code or download Smart Life on App store.

2.Registration or Log in.

- Download “Smart Life” Application
- Enter the Register/Login interface; tap “Register” to create an account by entering your phone number to get verification code and “Set password” .Choose “Log in” if you already have a Smart Life account.



Add Devices

- ① Connect power to gateway Confirm that the LED indicator (red) blinks. (If the indicator is in a different state, press the reset button until red indicator blinks);



- ② Make sure Bluetooth switch of the mobile is on, and a mobile is connected to the 2.4 GHz WiFi of home router, at this point, the mobile phone and gateway in the same local area network;

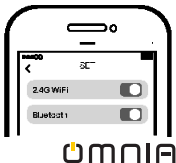

- ③ Open the APP, will find gateway automatically, click “Add” .if don't find gateway then click the “+” in the upper right corner of the screen, select “Gateway Control” in the left menu bar on screen, and choose “Multi-mode Gateway”, press function button until LED indicator blinks, operate according to directions;



- ④ Enter the Wi-Fi password, click "Next", and wait for the connection to complete. Add the device successfully, you can edit the name of the device to enter the device page by click "Next"

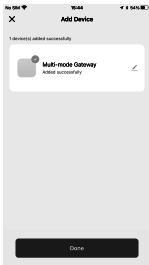

- ⑤ Once the device has been added successfully, you will be able to find the device on the "My Home" page .

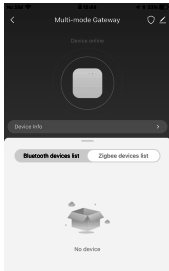

⊕ Add devices

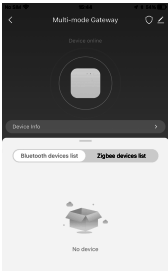

⊕ Add devices

Electronic Information Products Toxic And hazardous substance Declaration

Part name	Toxic or harmful substances or elements				
	Lead Pb	Mercury Hg	Cadmium Cd	Hexavalent chromium Cr(VI)	Polybrominated biphenyl PBB
PCB board	○	○	○	○	○
Housing	○	○	○	○	○
Cable	○	○	○	○	○

O: Indicates that the content of this toxic and hazardous substance in all homogeneous materials of this part is below the maximum limit specified in SJ/T1163-2006 Requirements for Concentration Limits for Certain Hazardous Substances in Electronic Information Products;

X: Indicates that the toxic or hazardous substance contained in at least one of the homogeneous materials of the part exceeds the maximum limit specified in the SJ/T1163-2006 standard

- 10** The figures in this label indicate that the product has an environmental protection use period of 10 years under conditions of normal use, and some parts may also have an environmentally friendly use period mark. The environmental protection use period is based on the number indicated by the mark.

FCC compliance statement

FCC Compliance Statement for OMHUB-C This device complies with Part 15 of the FCC Rules. Operation is subject to the following two conditions: (1) This device may not cause harmful interference, and (2) this device must accept any interference received, including interference that may cause undesired operation.

Note: This equipment has been tested and found to comply with the limits for a Class B digital device, pursuant to Part 15 of the FCC Rules. These limits are designed to provide reasonable protection against harmful interference in a residential installation. This equipment generates, uses, and can radiate radio frequency energy and, if not installed and used in accordance with the instructions, may cause harmful interference to radio communications. However, there is no guarantee that interference will not occur in a particular installation. If this equipment does cause harmful

interference to radio or television reception which can be determined by turning the equipment off and on, the user is encouraged to try to correct the interference by one or more of the following measures:

- Reorient or relocate the receiving antenna.
- Increase the separation between the equipment and receiver.
- Connect the equipment into an outlet on a circuit different from that to which the receiver is connected.
- Consult the dealer or an experienced radio/TV technician for help.

This device complies with Part 15 of the FCC Rules.

Operation is subject to the following two conditions: (1) This device may not cause harmful interference, and (2) this device must accept any interference received, including interference that may cause undesired operation. Changes or modifications not expressly approved by the party responsible for compliance could void the user's authority to operate the equipment. FCC Radiation Exposure Statement:

This equipment complies with FCC radiation exposure limits set forth for an uncontrolled environment. End users must follow the specific operating instructions for satisfying RF exposure compliance. This transmitter must not be co-located or operating in conjunction with any other antenna or transmitter.



WARRANTY INSTRUCTIONS

Dear Sir or Madam, thank you for purchasing the product.

We hope you'll enjoy using it.

The warranty for the products in the warranty card is hereby granted as follows.

As a condition of using the warranty, you must comply with the following terms and procedures:

1. Products are covered by a 24-month warranty, effective from the date of purchase of the covered product by a retail customer.
2. In order to exercise warranty rights, the purchaser must present: a) Warranty card, b) Proof of purchase (VAT invoice, financial receipt or other document confirming the actual date of purchase), unless the purchase date of the product comes from the warranty card.
3. If product quality problems occur within 24 months from the date of receipt, please prepare the product and packaging and go to the place or store where you purchased it to apply for after-sales maintenance. If the product is damaged due to personal reasons, a certain maintenance fee will be charged.
4. We recommend that you properly protect the goods when delivering them to the guarantor - for this purpose, we recommend that you use the original packaging with padding to ensure safe transportation. If you choose to use replacement packaging, we recommend that you ensure that the product is adequately protected from damage during shipping. We recommend that you place an appropriate sticker on your packaging indicating the product's susceptibility to impact, such as "Warning Glass".

5. Reported defects covered by the warranty will be considered immediately and no later than 14 days from the date of delivery of the goods to the Guarantor.

6. After checking and determining the legality of the warranty claim, the Guarantor's services will repair the product within a reasonable time, not exceeding 30 days from the date of delivery of the goods to the Guarantor. However, if hard-to-find spare parts are required, this deadline may extend the time it takes to deliver the part from the manufacturer's factory.

7. The warranty does not include the performance of maintenance and similar operations specified in the user manual, and users are obliged to do it themselves.

8. If defects occur due to natural wear and tear during use, the warranty does not cover it.

9. The warranty does not cover:

- a) Mechanical damage caused by the user's fault and product defects caused by such damage.
- b) Damage caused by improper use of the product.

10. The rights under the guarantee will expire in the following circumstances:

- a) Remove the warranty seal from the product.
- b) Remove the serial number from the product.
- c) Take action to eliminate physical defects in the product outside of authorized service.
- d) Use non-original parts and consumables.



RECYCLING INFORMATION

All products marked with the symbol for separate collection of waste electrical and electronic equipment (WEEE Directive 2012/19 / EU) must be disposed of separately from unsorted municipal waste. To protect your health and the environment, this equipment must be disposed of at designated collection points for electrical and electronic equipment designated by the government or local authorities. Correct disposal and recycling will help prevent potential negative consequences for the environment and human health. To find out where these collection points are and how they work, contact the installer or your local authority.



FR

Cet appareil,
ses accessoires,
se recyclent

À DÉPOSER
EN MAGASIN



OU

À DÉPOSER
EN DÉCHÈTERIE



OMNIA

WARRANTY CARD

Product Information

Product

Name _____

Product Type _____

Purchase

date _____

Warranty Period _____

Dealer

Information _____

Customer's

Maintenance Records

Failure date	Cause Of Issue	Fault Content	Principal

The logo for OMNIA, featuring the word "OMNIA" in a bold, black, sans-serif font. A small yellow square is positioned above the letter "O".